



Installation Guide & User Manual

TeleTalker[®] Telephone

Enhanced Amplified Telephone System, Model TEL 004



TeleTalker® Telephone

Enhanced Amplified Telephone System, Model TEL 004 Installation Guide & User Manual

Contents	Page
Safety Information	4
Introduction	5
TeleTalker Features & Components	5
Controls	6
Installation Steps	7
Table/Desk Installation	8
Wall Plate Installation	8
Bare Wall Installation	9
TeleTalker Operation	10
Using The Amplify Function	10
Making A Call	10
Answering A Call	10
Using The TeleTalker With A Hearing Aid	10
In Case Of Difficulty	12
FCC Registration Notice	13
Interference Information, Part 15 of FCC Rules	14
Warranty	15

Important Safety Information

Statements in this manual preceded by the following words are of special significance.

WARNING!

Means there is the possibility of personal injury to yourself or others.

CAUTION!

Means there is the possibility of damage to the equipment.

Other information of particular importance has been placed in italic type.

WARNING!

The TeleTalker is capable of amplifying sounds to a very loud volume. It has been set to an appropriate volume level by your Authorized TeleTalker Dispenser. To prevent misuse of the phone by someone who is unfamiliar with its operation and capabilities, DO NOT remove the warning labels. Instruct all potential users in its proper operation. Do not let children play with the TeleTalker. When the AMPLIFY function is not activated, the TeleTalker functions as a normal telephone.

WARNING!

This telephone can produce very high (loud) sound levels. Always adjust controls to minimum settings before using the phone and alert other users that hearing damage can potentially result from misuse.

WARNING!

This product can be hazardous if immersed in water. To avoid the possibility of electrical shock, do not use it while in the bathtub or shower, or when you are wet. If you accidentally drop it into water, do not retrieve it until you have first unplugged the line cord from the modular wall jack and the power pack from the AC wall outlet. Do not plug the telephone back in until it has dried thoroughly.

Avoid using the telephone during electrical storms in your immediate area. Urgent calls should be brief. Even though your telephone company may be using protective measures to limit electrical surges from entering your home, absolute protection from lightning is impossible.

If you suspect a gas leak, report it immediately. But use a telephone away from the affected area. The telephones electrical contacts could create a tiny spark. While unlikely, it is possible that this spark could ignite heavy concentrations of gas.

Introduction

Congratulations on the purchase of your Model TEL 004 TeleTalker Enhanced Telephone. This state-of-the-art Williams Sound product is designed and built with premium quality parts, for your assurance of reliability.

The TeleTalker Enhanced Telephone is designed to improve the audibility and understandability of incoming voice signals by reducing unwanted line noise and improving the clarity of the sound signal by emphasizing the higher frequency speech sounds. The TeleTalker functions as an amplified telephone or as a normal telephone for users who don't need amplification

We suggest you read this owners manual carefully to become familiar with these features and how they work. The manual explains how to install, use, and care for your new TeleTalker Enhanced Telephone.

If you have any questions, just contact your Williams Sound Authorized Dispenser.

Features

- ▶ Adjustable volume and sound enhancement controls
- ▶ Acoustic gain variable, zero to 50 dB
- ▶ High intensity flashing ring indicator
- ▶ Hearing aid compatible through handset induction coupling or neckloop/direct audio input jack
- ▶ Dual purpose phone allows push button engagement of amplification and enhancement functions, return to normal phone levels upon hang-up
- ▶ Unique anti-feedback circuitry
- ▶ Dynamic Noise Reduction (DNR) to remove unwanted background noise
- ▶ Dynamic Signal Processing (DSP) to improve speech clarity
- ▶ Full 3 year warranty.
- ▶ Switchable for Tone or Pulse operation
- ▶ Audible ringer volume control, adjustable to Hi, Lo, and Off
- ▶ Adjustable ringer tone controls

Components

1. Handset
2. Base
3. Coiled handset cord
4. Wall cords
5. Power pack
6. Installation Guide & User Manual

Controls

Amplify Button:	Activates Amplify and Enhance functions.	Redial Button:	Redials last number dialed.
Amplify Indicator:	Lights when Amplify function is on.	Pulse/Tone Switch:	Selects Pulse (rotary phone systems) or Touch-Tone Dialing.
Enhancement Control:	Increases sound clarity. (High frequency boost)	Ringer Volume:	Adjusts Ringer volume level.
Volume Control:	Increases sound volume.	Ringer Tone Control:	Adjusts Ringer tone.
Ring Indicator:	Flashes when TeleTalker rings		

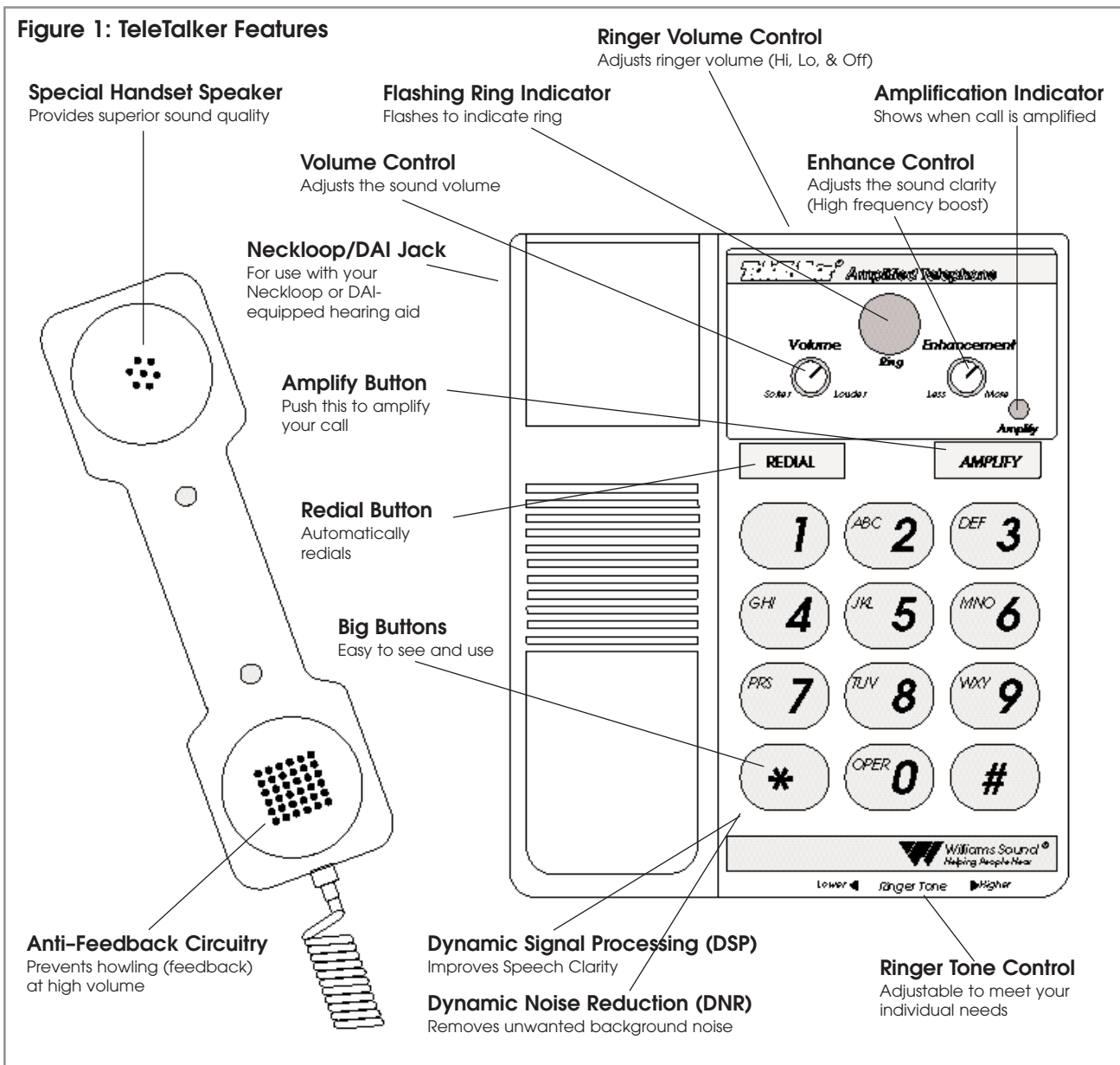

Installation Steps

Step 1: Make sure you have a 115 VAC wall outlet and telephone jack within 6 feet of the place you've chosen to install the telephone. If you have an older 4-prong jack, you'll need a modular jack adaptor. These adaptors are available from electronic, phone, and other retail stores.

Step 2: Place the Pulse/Tone Switch, located on the side of the phone, in either Tone (Touch-Tone) or Pulse (Rotary Dial Pulse).

Note: Make sure you choose the correct dialing mode. Tone dialing will not work if you have only dial pulse (rotary) service.

Step 3: Set Ringer Volume Control to desired level. (See Figure 2.)
If the ringer volume is not sufficient, contact your dealer for information about the Williams Sound RINGMAX™ Amplified Telephone Ringer.

Step 4: Plug the coiled handset cord into the handset. Plug the other end into the telephone base. (See Figure 3.)

Step 5: Plug Power Pack cord into the Power Jack located at the top end of the telephone. Plug the Power Pack into an unswitched AC outlet within 6 feet of the telephone (Figure 5).

Step 6: Perform either Table/Desk installation or Wall installation as outlined on the following pages.

Figure 2: Ringer Volume Control

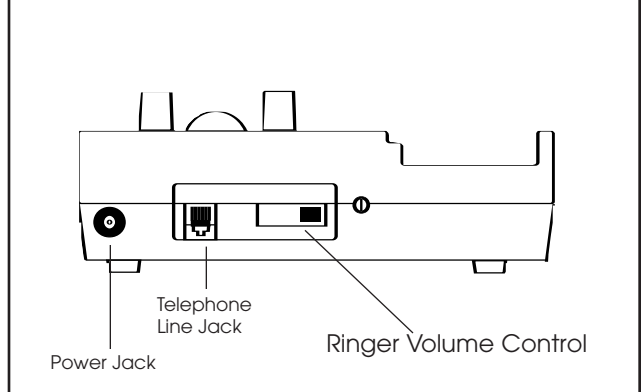

Figure 3: Handset Cord Connection

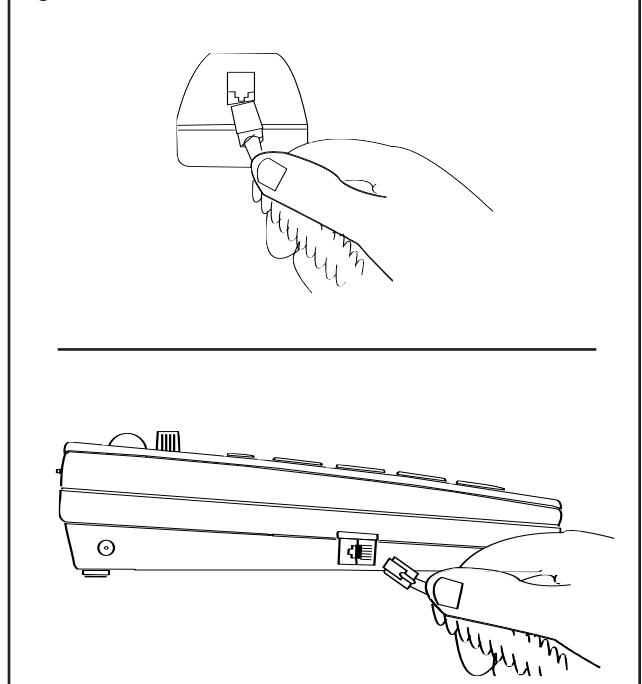
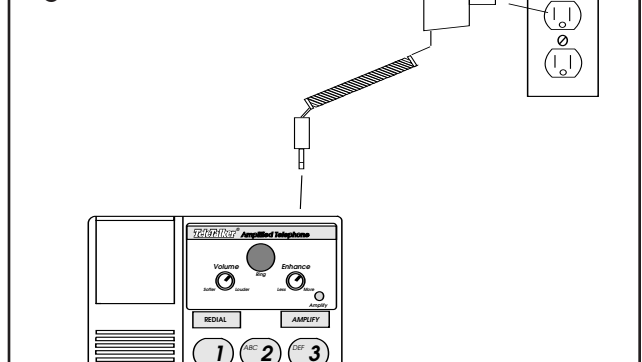

Figure 4: Power Connection



For Table/Desk Installations

- Step 1: Plug the long phone cord into the jack on the back of the telephone base.
(See Figure 5.)
- Step 2: Plug the free end of the line cord into a modular baseboard jack. Make sure all ends snap into place firmly.
- Step 3: Lift the handset and check for dial tone. If you don't hear a dial tone, see "In Case Of Difficulty", page 12.
- Note: To disconnect, squeeze the clip on the plug and pull out from the jack. Remove Power Pack plug from telephone.

For Wall Plate Installations

The TeleTalker can be mounted on a studded wall phone plate. If you don't have one installed, talk to your phone company or local phone products store.

- Step 1: Clip the Base Stand into bottom of the TeleTalker base unit. (See Figure 6.) Make sure the tabs snap in securely. This will make the base unit level with the wall.
- Step 2: Reverse the handset hanger to provide a hook preventing the handset from falling. (See Figure 8.)
- Step 3: Plug the short line cord into the jack on the top of the telephone and thread the line through the channel to the cavity on the back of the base unit.
- Step 4: Hold the telephone next to the wall-phone jack and plug the line cord into the jack, leaving any slack in the base unit cavity. Then push the phone against the mounting studs so the studs are hooked into the upper and lower slots of the phone. Slide the phone down until it snaps into place. (See Figure 7.)
- Step 5: Check for a dial tone. If you can't hear a dial tone, see "In Case Of Difficulty", page 12.

Figure 5: Line Cord Connection

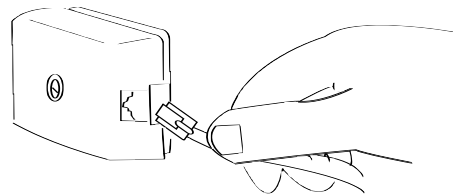
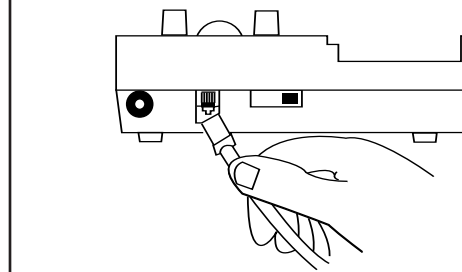

Figure 6: Base Stand For Wall Installations

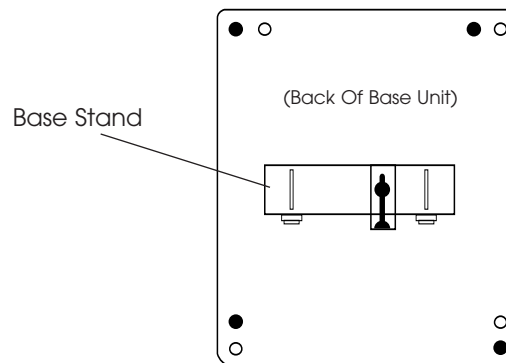
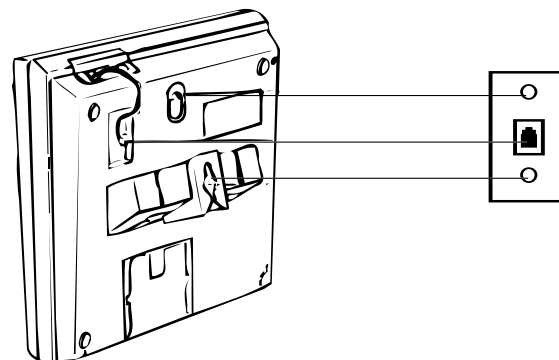

Figure 7: Installing on Wall Plate



Note: To remove a wall-mounted telephone, slide the phone up and pull it slightly away from the wall. Squeeze the clip on the modular plug and pull it from the jack.

Bare Wall Installation

Even if you don't have a studded wall phone plate, you can still mount the TeleTalker on any wall surface within seven feet of a standard modular jack and AC outlet. To mount the phone farther from the jack you'll need a longer line cord or a telephone extension cord. Place the AC power pack in a location which will not be subject to disturbance.

- Step 1: Measure and mark the wall for mounting screws.
Mark two points 3-¼ inches apart for upper and lower mounting screws. The lower mark should be 48–52 inches from the floor. Use a level to make sure the marks are in vertical alignment.
- Step 2: Install the mounting screws.
Use wood screws for stud mounting, anchor screws for hollow wall mounting. Drive the screws almost completely in, leaving a ⅛ inch space between the wall surface and the bottom of the screw head (about the thickness of two stacked pennies).
- Step 3: Reverse the handset hook.
(See Figure 8.)
- Step 4: Mount the TeleTalker.
Hang the telephone on the mounting screws and push down gently until it snaps into place
- Step 5: Connect the line cord to the wall jack.
Plug the free end of the line cord into a modular base-board jack. Make sure it snaps firmly into place.
- Step 5: Connect the AC power pack to a wall AC outlet.

Figure 8: Handset Hanger Change

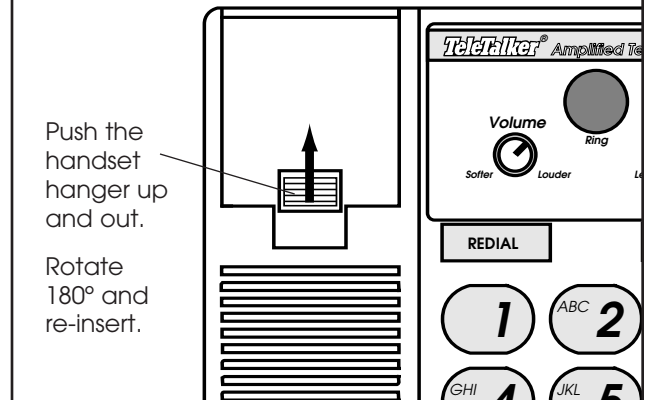

- Step 6: Check for the dial tone.
If you can't hear a dial tone, see "In Case Of Difficulty", page 12.
- Note: To disconnect the telephone, squeeze the clip on the modular plug and pull it out of the jack.

TeleTalker® Operation

Using The Amplify Function

Before activating the Amplify function, turn the volume and enhancement controls to minimum (Counter-clockwise). To activate, press the red Amplify button. The red amplify indicator light will glow when activated. The Amplify function automatically turns off when you hang up the phone.

Using The Volume Control

Turn Clockwise to increase volume,
Counterclockwise to decrease.

Using The Enhancement Control

Turn Clockwise to increase sound enhancement,
Counterclockwise to decrease.

Making A Call

- Step 1: Lift the handset and check the Volume Control setting.
- Step 2: Press the Enhance button. The Red LED should light.
- Step 3: Adjust the Volume and Enhance Controls to comfortable levels.
- Step 4: When you hear a dial tone, dial the number and use as a regular phone. Adjust the volume and enhancement controls for best understanding of the remote party.
- Step 5: When you hang-up the phone, the Amplify function automatically turns off.

Answering A Call

- Step 1: Check the Volume Control settings, lift the handset.
- Step 2: Press the Amplify button. The red Amplify indicator should light.
- Step 3: Adjust the Volume and Enhance controls to comfortable settings.
- Step 4: When you hang-up the phone, the Amplify function automatically turns off.

Using the TeleTalker With A Hearing Aid

The Neckloop/Direct Audio Input Adaptor allows the output of the TeleTalker to be coupled to hearing aids that have a telecoil (T-switch) or Direct Audio Input (DAI) jack.

Telecoil Option

The handset can be used directly with hearing aids equipped with a telecoil (T-coil). Move your hearing aid T-switch to the “T” position and hold the handset close to your hearing aid. The volume can be adjusted with the TeleTalker volume control.

Neckloop Option

If your hearing aid has a telecoil, plug the optional Neckloop accessory (NKL 001) into the Neckloop/DAI Jack as shown and place the loop over your head. Move your hearing aid control switch to the “T” position and operate the TeleTalker according to the instructions above. Adjust your hearing aid volume control and the TeleTalker volume control for a comfortable listening level.

WARNING!

The TeleTalker is capable of amplifying sounds to a very loud volume. It has been set to an appropriate volume level by your Authorized TeleTalker Dispenser. Always set the VOLUME CONTROL to the minimum setting before using the system. To prevent misuse of the phone by someone who is unfamiliar with its operation and capabilities, DO NOT remove the warning labels. Instruct all potential users in its proper operation. Do not let children play with the TeleTalker. When the Amplify function is not activated, the TeleTalker functions as a normal telephone.

Figure 9: Using The TeleTalker With Your Hearing Aid

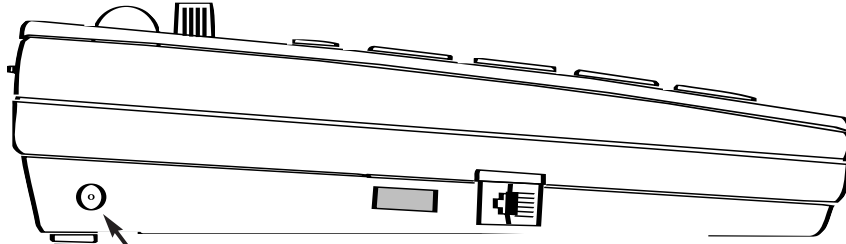

If you use a hearing aid, plug your Neckloop Accessory or DAI Cord into the Neckloop/DAI Jack located here.

DAI Option

If your hearing aid has a DAI input jack, connect the DAI cord supplied with your hearing aid to the Neckloop/ DAI Adaptor as shown. Operate the TeleTalker according to the instructions above. Adjust your hearing aid volume control and the TeleTalker volume control for a comfortable listening level.

If your TeleTalker does not work properly, refer to “In Case Of Difficulty” on page 12, and make any correction before seeking repair assistance.

In Case Of Difficulty

Problem	Possible Cause	Solution
Cannot hear the other person speak at the same time you are speaking. This only occurs when the TeleTalker is in “Amplify” mode.	<ol style="list-style-type: none"> 1. The TeleTalker is operating in Half-Duplex mode. Because of the extremely loud volumes which the TeleTalker produces, feedback would occur if your handset speaker did not shut off when you speak. 	<ol style="list-style-type: none"> 1. Do not speak when the other party is speaking. While you speak, you will shut off the handset speaker.
There is no dial tone when you pick-up handset	<ol style="list-style-type: none"> 1. Cords on handset or phone are not plugged into jacks. 2. Cord is damaged. 3. Wall jack is improperly wired. 4. Power pack not plugged in or outlet is dead. 5. Your phone line is out of order. 	<ol style="list-style-type: none"> 1. Make sure connectors are plugged in securely. 2. Replace cord. 3. Check wall jack for proper wiring. 4. Plug power pack into outlet. Check outlet with 115 Volt lamp. 5. Call your local phone company.
Can make calls, but phone doesn't ring for incoming calls.	<ol style="list-style-type: none"> 1. Handset is not placed properly on base 2. Ringer volume control is set to off 3. Too many phones/phone devices connected to the same line 4. Pulse/tone switch in wrong position. 5. Older extension phone causes TeleTalker to cut off. 	<ol style="list-style-type: none"> 1. Make sure handset is properly set on base. 2. Adjust Ringer volume switch to Lo or Hi. 3. Remove other phones or devices from line. 4. Your phone line may be set-up to accept only pulse dialing. 5. Use the TEL 007 Equalizer Accessory with the extension phone.
Can answer calls but cannot make them	<ol style="list-style-type: none"> 1. Pulse/ tone switch in wrong position 	<ol style="list-style-type: none"> 1. Switch Tone/Pulse to Pulse operation

FCC Registration Notice

Your new TeleTalker product has been registered with the Federal Communications Commission (FCC). This product complies with standards in Part 68 of the FCC Rules. The FCC requires us to provide you with the following information:

1. Connection and use with the nationwide telephone network

The FCC requires that you connect your product to the nationwide telephone network through a modular telephone outlet or jack. The modular telephone outlet or jack to which the telephone must be connected is a USOC RJ-11C or RJ-11W.

This equipment may not be used with Party Line Service or with Coin Telephone Lines.

2. Notification to the telephone company

The FCC requires that upon request of your local telephone company, you provide the following information:

- A. The 'line' to which you will connect the telephone equipment (your phone number).
- B. The telephone equipment's FCC registration number and Ringer Equivalence Number (REN). These numbers are on the back or bottom of your telephone equipment.

The REN is useful to determine how many devices you may connect to your telephone line and still have them ring when your telephone line is called. In most, but not all areas, the sum of all REN's should be 5 or less. You may want to contact your local telephone company if you experience problems.

3. Repair instructions

If it is determined that your telephone equipment is malfunctioning, the FCC requires that it not be used and that it be unplugged from the modular outlet until the problem has been corrected. Repairs to this telephone equipment can only be made by the manufacturer or its authorized agents or by others who may be authorized by the FCC. For repair procedures,

follow the instructions under the section entitled Warranty.

4. Rights of the telephone company

If your product is causing harm to the telephone network, the telephone company may temporarily discontinue your telephone service. If possible, they will notify you before they interrupt service. If advance notice isn't practical, you'll be notified as soon as possible. You'll be given the opportunity to correct the problem, and you'll be informed of your right to file a complaint with the FCC.

Your telephone company may make changes in its facilities, equipment, operations, or procedures that could effect the proper functioning of your TeleTalker product. If such changes are planned, you'll be notified.

5. This telephone is compatible with inductively coupled (Telecoil) hearing aids.



Interference Information: Part 15 Of FCC Rules

Some telephone equipment generates and uses radio-frequency energy and, if not installed properly, may cause interference to radio and television reception.

Your TeleTalker product has been tested and found to meet the standards for a Class B computing device, as specified in Subpart J of Part 15 of the FCC Rules. These specifications are designed to provide reasonable protection against such interference in a residential installation. However, there is no guarantee that interference will not occur in a particular installation.

If your TeleTalker product causes interference to radio or television reception when it's in use, you might correct the interference with any one of these measures.

1. Where it can be done safely, re-orient the receiving telephone or radio antenna.
2. To the extent possible, relocate the television, radio or other receiver with respect to the telephone equipment.
3. If your telephone product runs on AC power, plug your product into an AC outlet that's not in the same circuit as one used by your radio or television.



Warranty

Williams Sound Products are engineered and manufactured to give many years of trouble free service. Occasionally, latent defects will occur. If this happens, return the product to us with shipping cost prepaid and advise us by letter of the observed difficulty.

During the first five years following the date of purchase, we will promptly repair or replace the product and return it at our expense. After five years from the date of purchase, we will service our products for a modest service charge. Please return the enclosed warranty card to register your date of purchase.

This warranty does not extend to intentional or accidental physical damage, or damage caused by leaking batteries. Microphones, earphones, rechargeable batteries and chargers, headphones, and cables are warranted for 90 days. This warranty applies only to products returned to Williams Sound for service.

To return a product for service, call the phone number below and request a Return Authorization (RA) number. Unauthorized modifications or repairs of the product will void the warranty.

Williams Sound Corp.
10399 West 70th Street
Eden Prairie, MN 55344-3459

Phone: 1-800-843-3544

1-612-943-2252

Fax: 1-612-943-2174



TeleTalker® SPECIFICATIONS

TeleTalker Amplified Telephone, Model TEL 004

Dimensions:	3 ½" D, 8 ¼" H, 5 ½" W
Color:	Light Grey
Volume Variation:	10 dB, 15 dB, 20 dB, or 25 dB
Ringer Volume:	88 dB SPL
Audio Freq. Response:	300 Hz to 3800 Hz, + 3 dB
Acoustic Output Adjustable To Limit To:	115 dB, 120 dB, 125 dB, 131 dB
Total Harmonic Distortion:	2% Max. at rated output
Signal to Noise Ratio:	60 dB, NAB Weighted
High Frequency Boost:	30 dB Maximum
Maximum Acoustic Gain (Volume & Enhancement At Maximum):	50 dB
Signal Processing	Dynamic Signal Processing (DSP)
Noise Reduction	Dynamic Noise Reduction (DNR)*
Warranty:	Five Years, Parts & Labor

* DNR is a registered trademark of National Semiconductor Corporation